

PAR 64,56,46 HANGING AND RELAMPING INSTRUCTIONS

The Thomas PAR lanterns are to be hung with either a single hook clamp with bolt set (part number D0003), a variable hook clamp (D0101 with G0061 bolt set), an extruded pipe clamp (G0395), or mounted to an appropriate surface that is mechanically sound. Caution- injury to persons and damage to the lamp and/or mounting surface may result if the fixture is pulled from the surface. To reduce the likelihood of such injury or damage, mount only to a surface that is mechanically sound. To install a hanging device as listed above, install bolt through hole provided in yoke using washers either side of yoke and tighten nut (or bolt) to the proper torque.

To replace the lamps on PAR 64,56,46 units, disconnect the unit from the electrical supply and allow the unit to cool. Pull up on the spring plunger (the spring plunger does not remove). Remove the back cap in a back and downward motion (notice the alignment pin in the back cap and hole in the fixture body). Remove the ceramic connector from the lamp. Squeeze the lamp retaining ring and remove from unit. Remove lamp from fixture. Reverse the steps above to install the new lamp.

Note: the unit shown below is a PAR 64 professional series. It has a lamp adjuster and does not have an alignment pin as the back cap is attached to the fixture body.

Figure 1

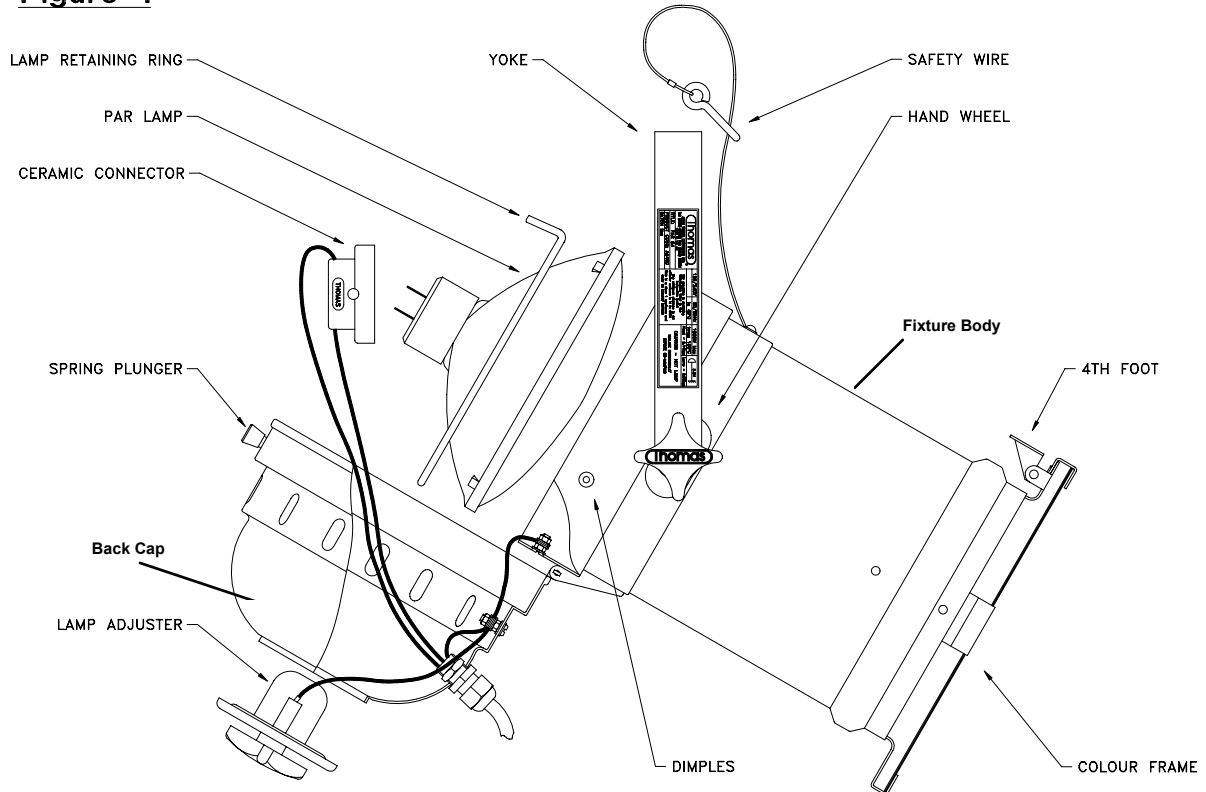

Please retain this instruction leaflet for future reference