

ENGINEERING

20.5" x 30" truss is for those ever increasing load requirement situations. The truss is connected together with bolts as standard and can be used with a Ground Support System by using suitable Sleeve Blocks and Towers. This truss can also be specified with castor wheels. The main chords of the truss are made from 2" x 0.157" and the diagonals are 1" x 0.125". Aluminum Alloys are either 6061T6 or 6082T6.

PRODUCT CODE	DESCRIPTION	WT lbs
B0900	10' section	79.5
B0901	8' section	72.5
B0902	5' section	66
B4900	4m section	105.5
B4901	3m section	79.5
B4902	2.5m section	73.5
B4903	2m section	66
B4904	1.5m section	60
B4905	1m section	53
B4906	2 way corner block	35
B4907	3 way corner block	37.5
B4908	4 way corner block	40
PRODUCT CODE	TRUSS WITH CASTORS	WT lbs
B0920	10' section	97
B0921	8' section	90
B0922	5' section	83.5
B4920	4m section	123.5
B4921	3m section	97
B4922	2.5m section	91
B4923	2m section	83.5
B4924	1.5m section	77
B4925	1m section	70.5

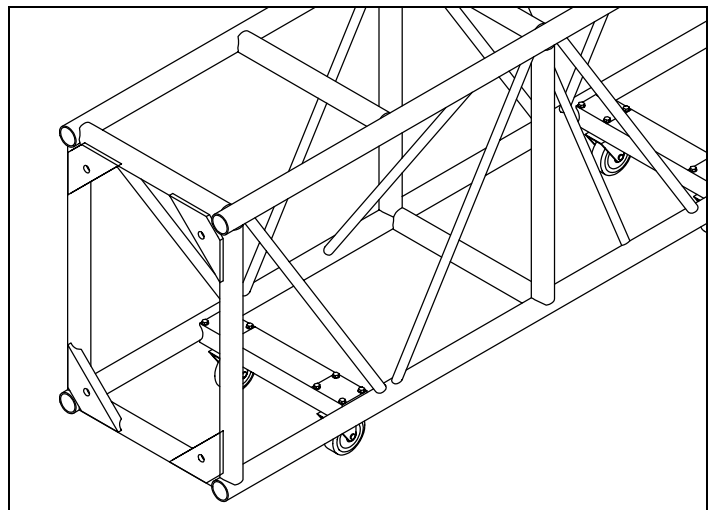
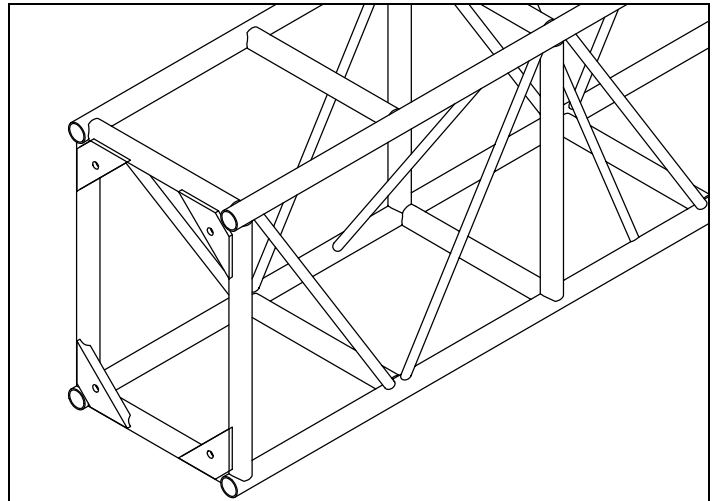

Allowable Load Data	Maximum Allowable Uniform Loads		Maximum Allowable Center Point Loads	
	Span feet (meters)	Loads pounds (kgs)	Maximum deflection inches (mm)	Loads pounds (kgs)
10 (3.048)	5646 (2561)*	0.236 (6)	5646 (2561)*	0.315 (8)
20 (6.096)	5646 (2561)*	0.236 (6)	5646 (2561)*	0.315 (8)
30 (9.144)	5562(2523)*	0.709 (18)	4202 (1906)	0.709 (18)
40 (12.192)	4127 (1872)	1.65 (42)	2063 (936)	1.65 (42)
50 (15.24)	3150 (1429)	2.05 (52)	1574 (714)	2.05 (52)
60 (18.29)	2460 (1116)	2.80 (71)	1230 (558)	2.80 (71)
70 (21.34)	1953 (886)	3.66 (93)	976 (443)	3.66 (93)

LOADING FIGURES show maximum loads between supports in addition to self weight of truss. Information extracted from structural report by Broadhurst, Goodwin & Dunn for truss manufactured after November 1993. * Denotes load limited to suit maximum shear capacity. All loads include 20% overload factor for dynamic effects.

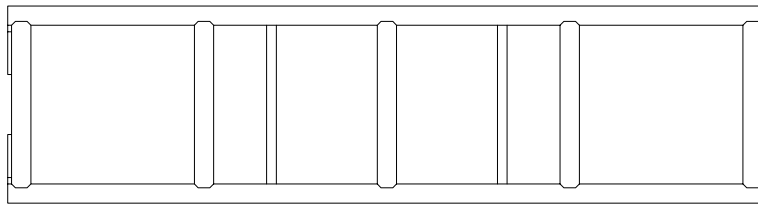

Plan View

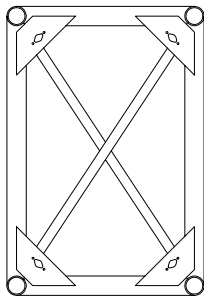

End View

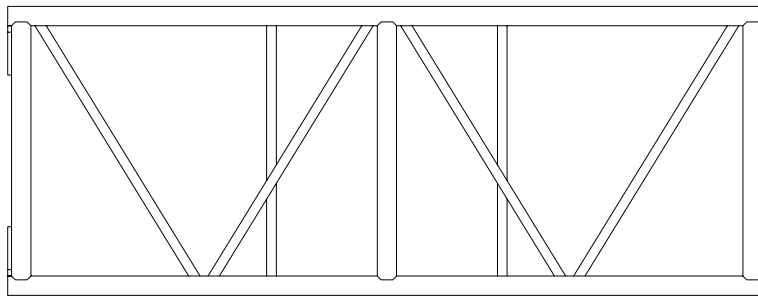

Side View

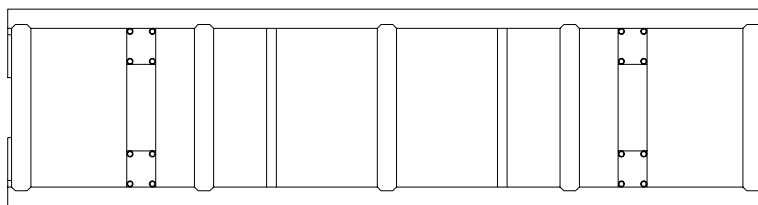

Plan View

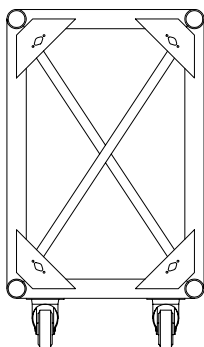

End View

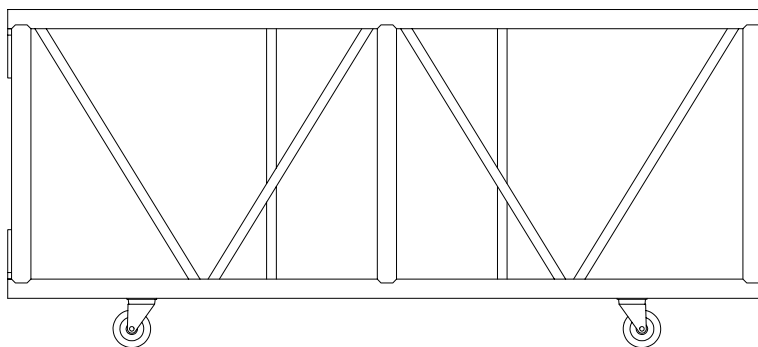

Side View