



# MOVING LIGHT SUPERTRUSS

Moving Light supertruss has been designed around the Pre-rigged supertruss size. 96" x 30" x 26" in size (other sizes are available). Moving light supertruss provides a substantial increase in load bearing capacity over the flat plate pre-rigged truss. It is manufactured from aluminium tube 6061-T6 or 6082-T6 with 2" x .157" wall thickness for main tubes and 1" x .125" wall tube for the diagonals. Each truss piece has 8 castor wheels for easy maneuverability and pins and R-clips for the connection of truss pieces.

Each 96" truss is designed to carry 3 moving light fixtures. The moving lights are stored internally in the truss and can be lowered to the working position when in use. This design reduces the amount of space required for lighting and rigging in the truck. .

Two handles allow the lowering of each moving light. The following units have been tried in our moving light trusses:

Highend Studio Color and Studio Spot.

Coemar CF7 wash fixture

Martins line of Mac fixtures; 250, 300, 500, 600, and 2000

Other fixtures may fit within the design of this truss by using a custom fitted plate.

The whole system can be used with our Ground Support System by using suitable sleeve blocks and towers.

Please note: no fixtures are included with truss.

PRODUCT CODE	DESCRIPTION	WT lbs
MLT-ST-96-R1	8' section (empty)	145**
B1400	60 Degree corner gate	36
B1401	90 Degree corner gate	16
B1402	120 Degree corner gate	12.1
B1403	135 Degree corner gate	11
B1306	Vertical connecting fork	1.3
B1307	Horizontal connecting forks 2/unit	2.2
B1404	3 Way gate	14
B1405	3 Way gate with lifting point	-
B1408	Square support plate	16
B1409A	12" Tower sleeve plate	51
B1409B	15" Tower sleeve plate	49
B1411	Super-truss to P.R.T. adapter plate	-
B1413	Lifting point for P.R.T.super-truss	-
	** weights subject to change	

# SUPER MOVING LIGHT TRUSS

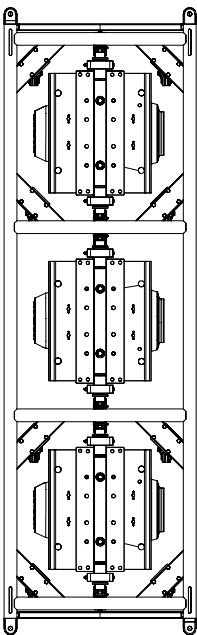
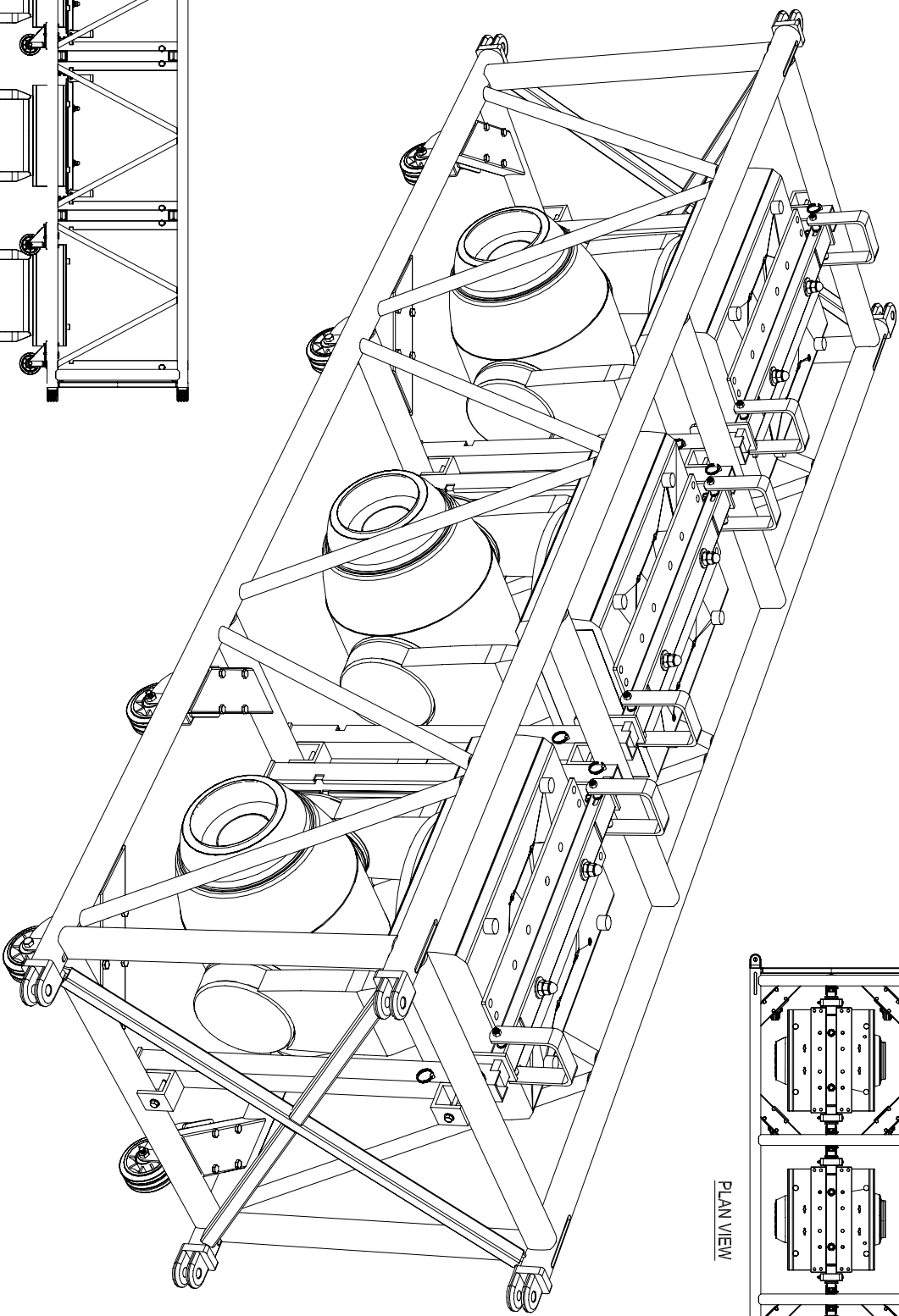

PLAN VIEW

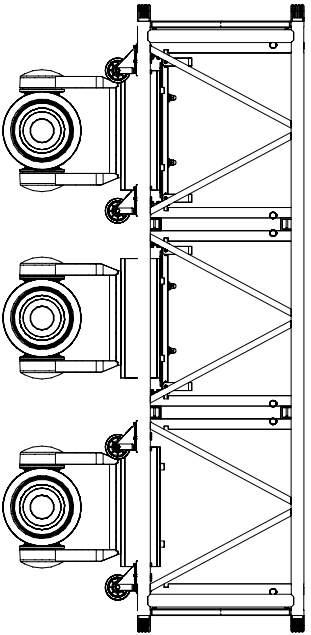

FRONT VIEW WITH LIGHTS IN LOWERED POSITION

**SUPER MOVING LIGHT TRUSS**  
**30" WIDE X 26" TALL**

ACCOMMODATES WIDE VARIETY OF MOVING LIGHTS  
\*SIZE SHOWN IS 6'